

# 360° living 100% privacy

Unique hub and spoke apartments with excellent connectivity



GM INFINITE

*Daffodils*

YESHWANTHPUR





GM Infinite Daffodils is an exclusive residential community spread across 4.5 acres of lush greenery, comprising of 494 apartments as good as independent homes and an international standard clubhouse. Strategically located close to Yeshwanthpur, Daffodils offers you a luxurious lifestyle.

Daffodils is a set of unique hub and spoke apartments, the first of its kind in design and concept. These apartments do not share common walls with neighbours, have large windows for ventilation and the entire living space is designed to offer a scenic view of the natural surroundings.

Daffodils is on 100 feet Road, which is now the route to the international airport. There is excellent connectivity by the metro that's 0.5 km away. Daffodils is also conveniently located close to well known schools, colleges and hospitals.

### Route Map



### Know your neighbourhood

- Hessarghatta Metro Station – 0.5Kms.
- Yeshwanthpur Railway Station - 7 Kms.
- Jalahalli Cross - 2 Kms.
- NICE Corridor - 3 Kms.
- International Airport - 35 Kms.
- Chikkabanavara Railway Station - 1 Km.





Typical Floor plan of 3 BHK - Tower 1&5

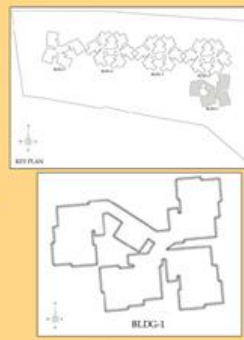

Unit plan of 2 BHK - SBA 1325 sq.ft.



Unit plan of 3 BHK - SBA 1650 sq.ft.

Typical Floor plan of 2 BHK - Tower 2, 3 & 4  
1<sup>st</sup> to 5<sup>th</sup> Floor  
13<sup>th</sup> to 19<sup>th</sup> Floor

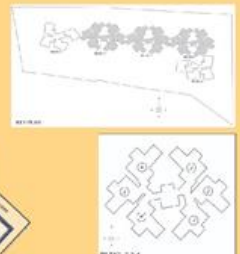



Unit plan of 2 BHK - SBA 1325 sq.ft.

Unit No : 1 & 3



Typical Floor plan of 2 BHK - Tower 2, 3 & 4  
6th to 12th Floor

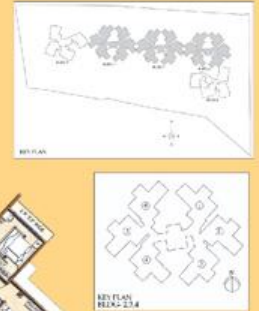

## Rewarding lifestyle amenities in and around the 10000sq.ft Clubhouse

- Bamboo garden • Designer fountain • Elder's walkway & park • Entry water feature
- Jogging track • Open lawn • Tree lined driveway • Swimming pool • Toddler's pool
- Tennis court • Basketball court • Netted cricket pitch • Children's play area
- Multipurpose hall • Gym / Fitness centre • Table tennis • Billiards • Reading room
- Carrom / Card room • Creche • Sauna • Jacuzzi







# Specifications

## Structure

TOWER 1, 2, 3, 4 & 5  
RCC framed structure  
Concrete block masonry  
Internal walls smoothly plastered with lime rendering

## Entrance Lobby & Security

- Granite for ground floor and vitrified tiles in upper floors
- Lift – cladding in granite
- Round the clock security and CCTV monitoring at the entrance gate
- Intercom system in each apartment and common areas from the entrance gate
- Security kiosk and letter boxes in each tower
- Number plate for each apartment

## Flooring

- Vitrified flooring in living, dining, bedrooms and kitchen
- Anti skid tiles and ceramic wall tiles in bathrooms/toilets
- Antiskid ceramic tiles for balconies

## Kitchen

- Black granite countertop with single bowl stainless steel sink
- 2 ft. dado with tiles above kitchen granite counter top
- Provision for water purifier and exhaust fan
- Provision for washing machine in utility area
- Reticulated gas connection

## Bathrooms

- White colored - wall mounted EWC/Sanitary ware with flush valve and wash basin
- Hot-cold water mixer units for head shower
- Provision for exhaust fan and geyser in all bathrooms
- Health faucet for all toilets
- Wall tiles dado upto 7 ft. height

## Doors and Windows

- Entrance door in teak wood frame with hard wood shutters, polished on both sides with fittings
- Internal doors with hard wood frame with flush shutters
- Powder coated/aluminium windows with sliding shutters and plain glass
- Marble top on all window sills

## Painting

- All interior walls – cement based putty with emulsion/ paint of approved shade
- Exterior facia of building – painted with weather-proof paint
- Grills and railings of balconies and staircases with enamel paint

## Lifts

- Two passenger lifts (automated) of reputed make

## Waste management

- Garbage collection system

## Power

Real Power : - 4KW for 2BHK  
6KW for 3BHK

Backup power: 0.75KW for 2 BHK  
1KW for 3BHK

## Electricals

- One ELCB for each flat
- One MCB for each room provided at the main distribution panel
- Concealed electrical copper wiring with circuit breakers
- Premium modular switches of reputed make in all rooms
- TV and telephone points in living and master bedroom
- AC point in living and master bedroom
- Power back up for lifts, pumps and common areas

## Parking

- Provision of parking in upper and lower basement level
- Well lit and numbered parking bays
- Easy access from lobbies with wide stair cases, elevators and walk-ways to gardens/upper floors

## Safety

- Sprinklers in all common areas and in living, kitchen and all the bedrooms of each apartment as per the norms of the Fire Dept.



GM Infinite is a group of dedicated professionals who has been building homes and developing properties in Bangalore for over 45 years. The company is one of the leading players in the thriving realty market in Bangalore, and with its experience and expertise, has emerged as one of the most reliable and trustworthy companies. Apart from designing comfortable and luxurious homes, the emphasis at GM Infinite is about building homes that are affordable. This focus has enabled GM Infinite to empower the dreams of many with a home of their own. Each of GM Infinite's successes has transformed the lives of many and this is what sets it apart from others.

A trusted name for homemakers  
Over 45 years of experience in the construction business  
Homes that combine luxury and affordability  
Quality practices and policies

---

No.06, GM Pearl, BTM layout, 1st Stage, 1 Phase, Bangalore - 560 068.  
Tel : +91 80 4120 1909 Fax : +91 80 4120 1910

To own a home in Daffodils, call us on:  
+91 99000 15757 / 99000 25757 / 99000 35757 / 99000 45757  
or Email us at : [daffodils@gminfinite.com](mailto:daffodils@gminfinite.com)

[www.gmdaffodils.com](http://www.gmdaffodils.com)

Disclaimer: This brochure is purely conceptual and not a legal offering. The company reserves the right to amend / change plans, elevations, amenities etc. at any point of time without prior notice.